

Parts List

ITEM	QTY	PART #	DESCRIPTION
1	1	A01047	ADAPTOR
2	1	A02002	BASE
3	3	A02011	BEARING
4	2	A02014	ROD BOLT
5	2	A02028	VALVEBODY
6	1	A02033	BUSHING
7	4	A02038	BOLT-MOTOR
8	2	A03001	CAP
9	1	A05002-250	ECCENTRIC
10	4	A06001	FOOT
11	1	A08001	HOUSING
12	2	A08040	HEAD
13	1	A13052	MOTOR
14	4	A14001	CAP NUT
15	4	A14009	NUT
16	2	A16001	PLATE-DIAPH.
17	1	A16008	2nd STAGE
18	2	A18001	CONN. ROD
19	3	A18002	TOLERANCE RING
20	12	A19005	SCREW
21	2	A19007	PLATE SCREW
22	1	A19008	SET SCREW
23	1	A19010	SET SCREW
24	4	A19013	SCREW
25	4	A19018	HOUSING SCREW
26	4	A19031	2nd STAGE SCREW
27	4	A19037	SCREW ADAPTOR
28	1	A19050	SPRING PIN
29	4	A23004	WASHER
30	2	*A04001	DIAPHRAGM
31	2	*A07012	GASKET
32	4	*A15003	O-RING
33	4	*A22002	4-40 SCREW
34	4	*A22004	FLAPPER VALVE
35	2	*A22005	VALVE STOP
36	2	*A23001	WASHER

\*RECOMMENDED SPARE PARTS KITS

DIAPHRAGM KITS	
11012	TEFLON/EPDM
11014	3-PLY TEFLON
11017	VITON

INCLUDES ITEMS 30-36

**MOTOR DESCRIPTION:**

A13052 .25kW 115/230V 50/60Hz 1Ph

ALTERNATE PARTS LIST

A04001	DIAPHRAGM - TEFLON/EPDM
A04003	DIAPHRAGM - VITON
A04011	DIAPHRAGM - 3 PLY TEFLON

ADC-191 08/04/21

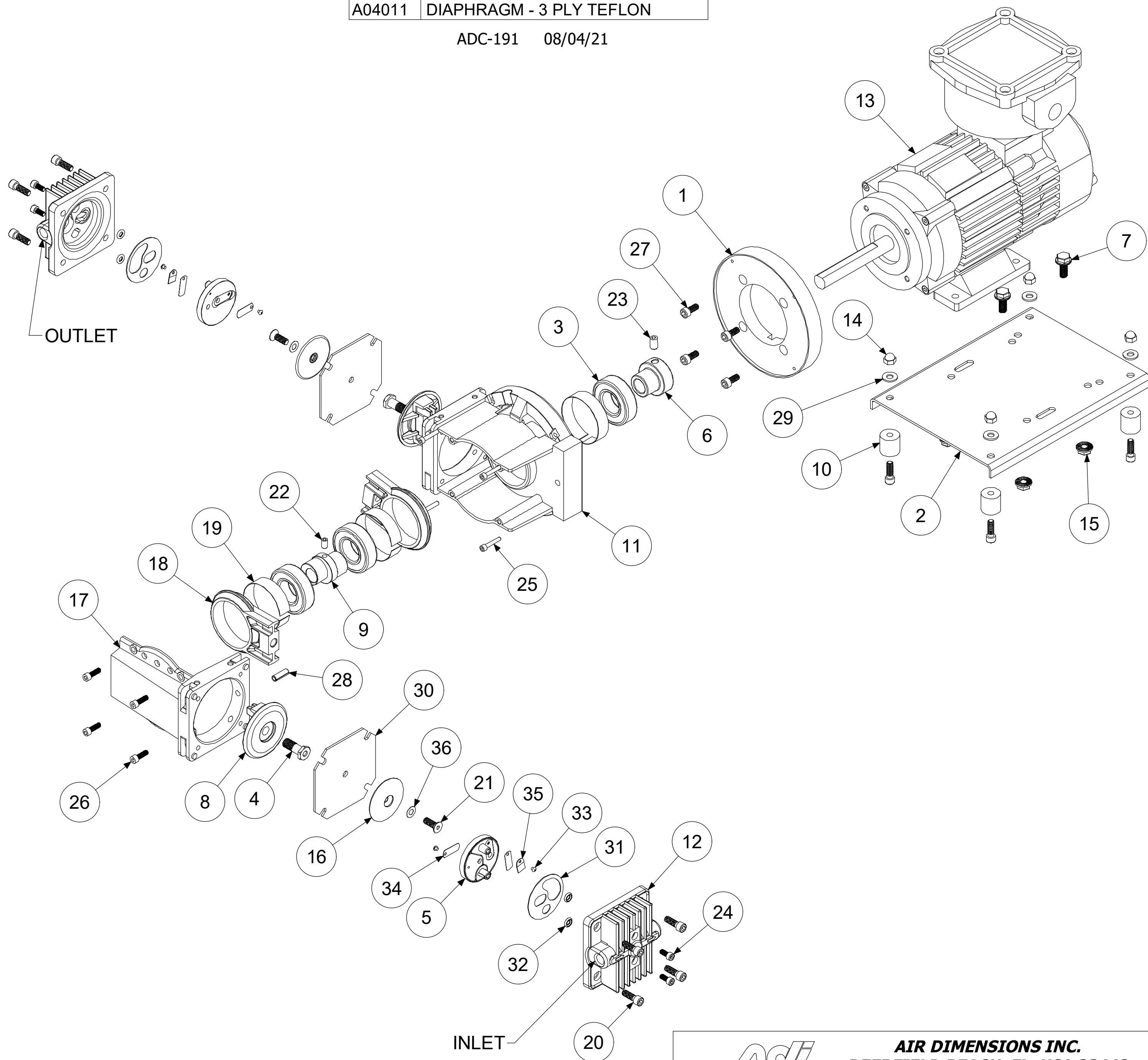

**AIR DIMENSIONS INC.**  
**DEERFIELD BEACH, FL. USA 33442**  
[WWW.AIRDIMENSIONS.COM](http://WWW.AIRDIMENSIONS.COM)

DATE 7/18/2016	TITLE RVA-Series Hi-Vac ATEX Pump
APPROVED BY FDM	DWG NO RVA2-Fx-GC5
	MODEL # RVA2-Fx-GC5
	SHEET 2 OF 2

08/21 (2198)