

Parts List			
ITEM	QTY	PART #	DESCRIPTION
1	1	A02005	VALVEBODY
2	1	A02311	BEARING
3	1	A02326	HOUSING
4	1	A02327	REAR HOUSING
5	2	A03012	HEATER
6	1	A03301	CAP
7	1	A03302	CWEIGHT
8	1	A03315	CAPACITOR
9	1	A05005	COVER
10	1	A05304	ECCENTRIC
11	1	A06303	FAN, WHITE
12	1	A06308	FAN, BLUE
13	1	A07020	GROMMET
14	1	A08023	HEAD, HEATED
15	1	A09031	INSULATION
16	1	A09301	INSERT
17	1	A09303	SPACER
18	1	A13314	MOTOR
19	3	A15003	O-RING
20	1	A16001	PLATE-DIAPH.
21	1	A18301	CONN. ROD
22	1	A18302	TOL. RING
23	6	A19013	VALVEBODY SCREW
24	4	A19017A	HEAD BOLT
25	1	A19044	HI-TEMP SPACER
26	1	A19301A	PLATE SCREW
27	1	A19303	GROUND SCREW
28	1	A19309	CWGT. SCREW
29	8	A19311	HSG. SCREW
30	1	A19313	CAPACITOR SCREW
31	2	A19321	SCREEN
32	6	A19322	SCREEN SCREW
33	1	A19345	MINI SPACER
34	2	A19428	SET SCREW
35	1	A20018	THERMOCOUPLE
36	1	A23402	WASHER
37	2	*A04004	DISC-VALVE
38	1	*A04312	DIAPHRAGM
39	1	*A07001	GASKET
40	1	*A23001	WASHER

ALTERNATE MOTORS

A13314 115/60/50/1
A13315 230/60/50/1

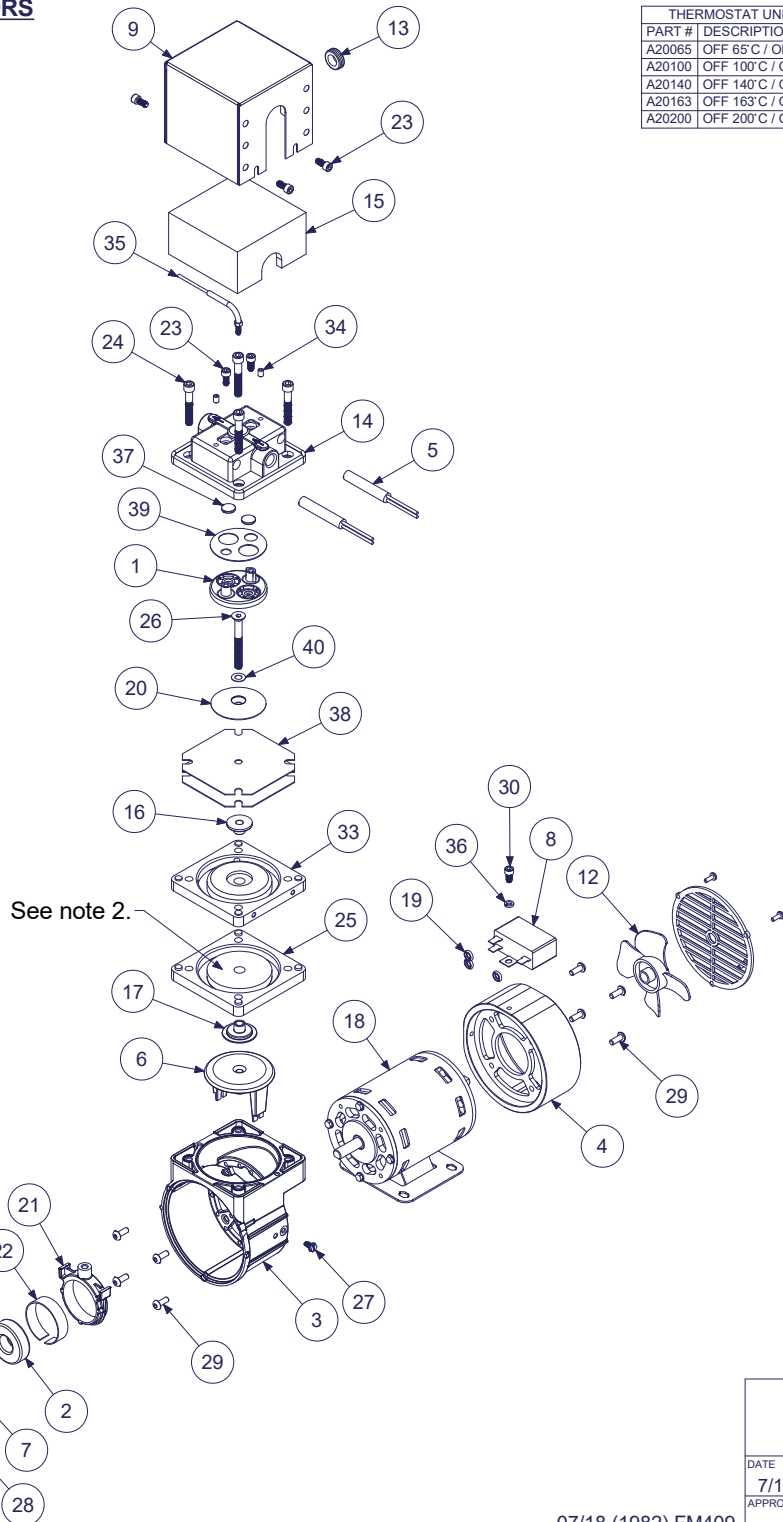

THERMOSTAT UNITS	
PART #	DESCRIPTION
A20065	OFF 65°C / ON 55°C
A20100	OFF 100°C / ON 90°C
A20140	OFF 140°C / ON 125°C
A20163	OFF 163°C / ON 143°C
A20200	OFF 200°C / ON 185°C

CAPACITORS
A03315 10uf for 115 volt motor
A03318 3uf for 230 volt motor

Notes:

- This pump is equipped with a thermocouple, RTD, or a thermostat. Please refer to the following.

A controller must be used with the thermocouple (A20018) or RTD (A18003) to prevent overheating, or
A thermostat may be used which does not require a controller.
- The lower round Valox spacer must be flipped 180° to face opposite direction of the upper spacer.

ALTERNATE AND OPTIONAL PARTS	
PART #	DESCRIPTION
A02005	VALVEBODY - 316ss
A02009	VALVEBODY - 316ss TFE CO
A02023	VALVEBODY - HAST C
A02024	VALVEBODY - HAST C TFE CO
A02075	VALVEBODY - ELECTRO POLISH
A02095	VALVEBODY - SILCONERT
A03012	HEATER - 110v 75 WATT
A03014	HEATER - 220v 75 WATT
A04308	DIAPHRAGM - TEFLON/EPDM
A04312	DIAPHRAGM - 2 PLY TEFLON
A04331	DIAPHRAGM - TEFLON/VITON
A08022	HEATED HEAD - HAST C
A08023	HEATED HEAD - 316ss
A08026	HEATED HEAD - HAST C TFE CO
A08027	HEATED HEAD - 316ss TFE CO
A08074	HEATED HEAD - ELECTRO POLISH
A08097	HEATED HEAD - SILCONERT
A16001	PLATE - 316ss
A16005	PLATE - 316ss TFE CO
A16020	PLATE - HAST C
A16021	PLATE - HAST C TFE CO
A16071	PLATE - ELECTRO POLISH
A16091	PLATE - SILCONERT
A19301A	PLATE SCREW - 316ss
A19302	PLATE SCREW - 316ss TFE CO
A19377	PLATE SCREW - ELECTRO POLISH
A19397A	PLATE SCREW - SILCONERT
A07001	GASKET - CARBON TEFLON
A07005	GASKET - VITON
A07906	GASKET - EPDM
A04004	DISC-VALVE - CARBON TEFLON
A04007	DISC-VALVE - 416 SS

***RECOMMENDED SPARE PART KITS**

DIAPHRAGM KITS	
11310	2-PLY TEF/VITON
11312	2-PLY TEFLON
11313	TEFLON/EPDM

INCLUDES ITEMS 37-40

ADS-123 02/28/17



AIR DIMENSIONS INC.
DEERFIELD BEACH, FL. USA 33442
WWW.AIRDIMENSIONS.COM

DATE 7/11/2018	TITLE Single Head Heated M-Series Pump
APPROVED BY FDM	DWG NO Mxx1-xx-Cx5-M
MODEL # Mxx1-xx-Cx5-M	SHEET 2 OF 2