

Parts List			
ITEM	QTY	PART #	DESCRIPTION
1	1	A02001	BASE
2	2	A02017	ROD BOLT
3	1	A02610	BEARING
4	2	A02611	BEARING
5	1	A02633	SHAFT BUSHING
6	1	A03003	CLAMP
7	2	A03601	CAP
8	1	A03602	COUNTERWEIGHT
9	1	A05601	ECCENTRIC
10	4	A06001	FOOT
11	1	A06606	ACCESS PLUG
12	1	A08601	HOUSING
13	2	A08603	HEAD
14	1	A13603	MOTOR-STATOR
15	4	A14001	CAP NUT
16	2	A16601	DIAPH. PLATE
17	1	A16607	COVER PLATE
18	2	A16608	COVER, HEAD
19	2	A18601	CONROD
20	1	A18602	TOL. RING
21	2	A18603	TOL. RING
22	4	A19005	SCREW
23	2	A19007	PLATE SCREW
24	1	A19008	SET SCREW
25	1	A19010	SET SCREW
26	16	A19013	SCREW
27	1	A19017	SCREW
28	8	A19605	HEAD BOLT
29	1	A19620	SPACER

Parts List			
ITEM	QTY	PART #	DESCRIPTION
30	6	A19651	ROLL PIN
31	4	A23004	WASHER
32	2	*A04601	DIAPHRAGM
33	2	*A07601	GASKET
34	4	*A22002	4-40 SCREW
35	4	*A22601	VALVE
36	2	*A22605	VALVE STOP
37	2	*A23001	WASHER

ALTERNATE PARTS LIST	
A03019	CONNECTOR - HUBBLE
A03045	CORD - POWER 115V
A03046	CORD - POWER 230V
A04601	DIAPHRAGM - TEFLON/EPDM
A04611	DIAPHRAGM - 3 PLY TEFLON
A07601	GASKET - VITON
A07607	GASKET - GRAPHITE

ADC-183 06/18/21

***RECOMMENDED SPARE PARTS KITS**

DIAPHRAGM KITS	
11605	TEFLON/EPDM
11611	3-PLY TEFLON
11612	3-PLY TEFLON (GRAPHITE GASKET)

INCLUDES ITEMS 32-37

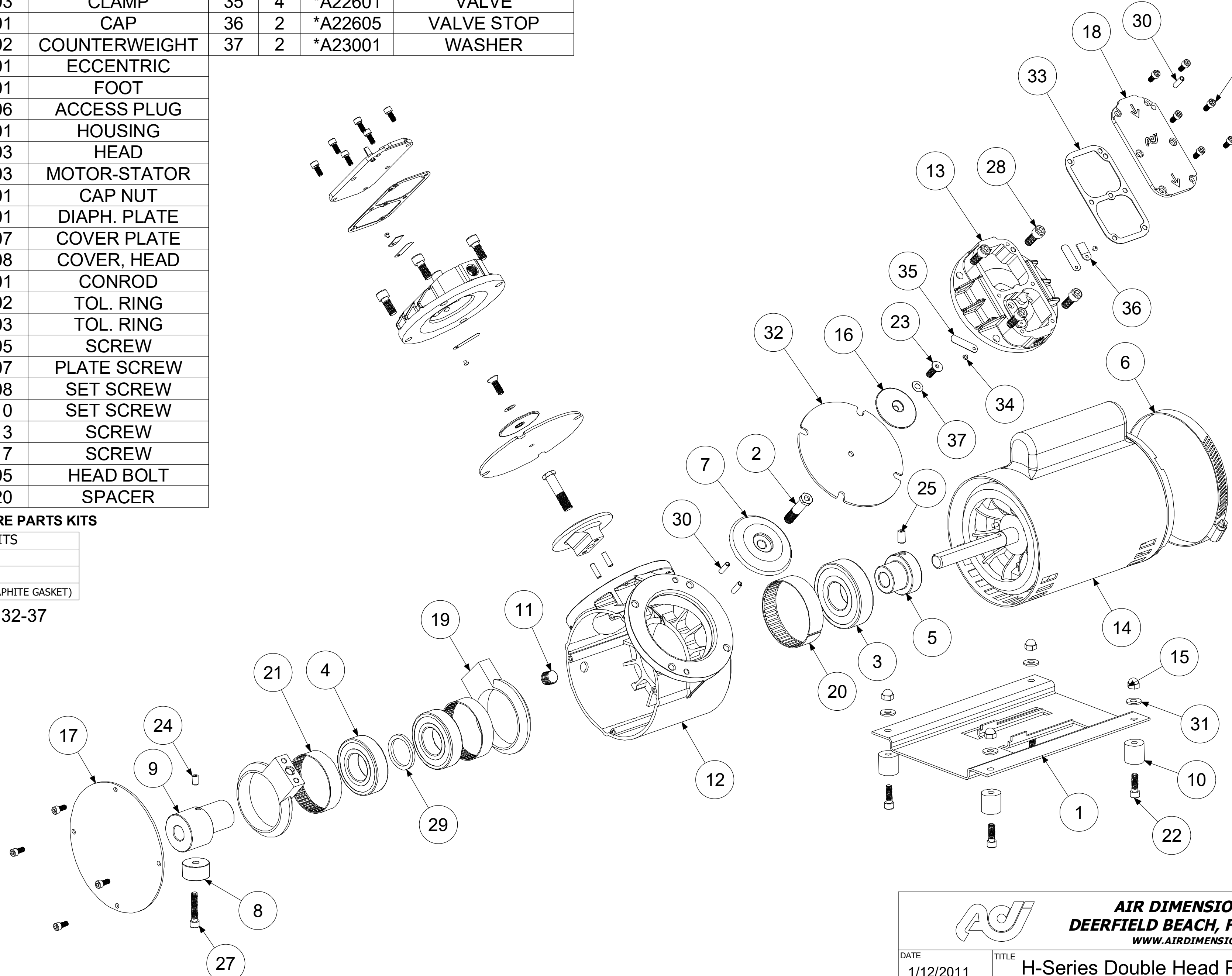

MOTOR DESCRIPTION:
A13603 1/2HP 115/230V 50/60Hz 1Ph

		AIR DIMENSIONS INC. DEERFIELD BEACH, FL. USA 33442 WWW.AIRDIMENSIONS.COM	
DATE	1/12/2011	TITLE	H-Series Double Head Pump
APPROVED BY	FDM	DWG NO	H302-Fx-AC5
		MODEL #	H302-Fx-AC5
		SHEET 2 OF 2	

06/21 (2186)